

A Very Easy Triangle Tea Bag Fold--- Windmill

I remember when I first received a card with a tea bag fold medallion on the front of the card, I actually peeled it off to find out how it was done. As a result I have kept the designs I have made in a folder to refer to whenever I download a teabag sheet offered for purchase from a cup designer. The design for this self- named windmill, which I have featured on the card I have made, is from the sheet cup 890398_3406 Lily of the Valley A6 Tea Bag Card, by Joy Jerome.

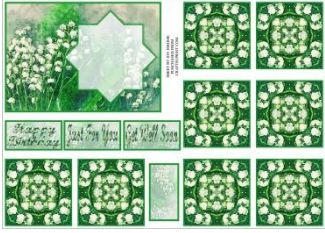

This is the sheet available for purchase.

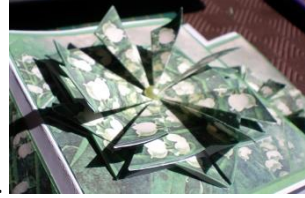

This photograph explains



why I gave it the name Windmill.

This is the photograph of one of the cards I have made using this sheet. I have already uploaded a tutorial for the half hidden tea bag fold on the card. Here is a



closer look at the finished windmill medallion in the flat position.



And the second photograph here is the back of the finished windmill medallion, which as you can see is also quite decorative.

A Very Easy Triangle Tea Bag Fold--- Windmill

1: Cut out all 8 tiles from whichever sheet you decide to use. I like to use regular copy paper and print a matching plain colour onto the back of the sheet and allow a couple of minutes for the ink to dry. I don't have a laser printer and the cartridges always are a little damp when first printed. This gives extra texture and stability to the paper and makes the folds firm, and helps avoid the white edges on the folds.

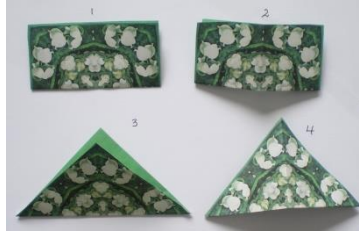

2: Make the 4 basic folds on each of the 8 tiles

3: Pinch the top central fold and collapse it down into a triangle shape.

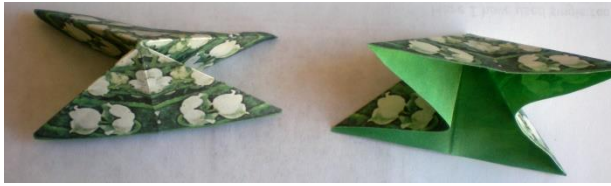

The 2 images here show the view from the top of the main corner fold point and looking in under at the throat of the fold. Remember to make all the folds very firm and as accurate as possible.

4: Flatten the triangle firmly before making the next fold.

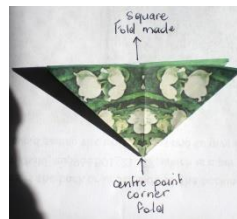

Take the right hand top half and fold it,



keeping the centre point tight, to meet the square fold line.

Make 8 of these.

5. Making the windmill is very easy.



Before applying any glue

slide tea bag 2 into position as shown in these photographs.



A Very Easy Triangle Tea Bag Fold--- Windmill



This is how it will

look when it is glued and flattened. For the purpose of explaining how to glue I have referred to the fold as a wing. I have used a fine brush and white glue and held the wing back to be able to apply the glue along the visible fold line originally



made in forming the first 2 folds which made a square in step 1:

and then

taken a second tea bag and slid it into place matching all points as much as possible and holding down firmly for 3 or 4



seconds to secure the glue hold.

I have used the tweezers



here to hold while I took the photograph. Attach tea bag 3 using the same method.



Remember to hold for 3 or 4 seconds before continuing. Join 7 tea bags

A Very Easy Triangle Tea Bag Fold--- Windmill



together. Joining # 8 is slightly different as it has to be joined to # 1.

This next photograph



has the tea bag in position but not yet glued.



I have held the tea bags loosely to make it easier to see. Now I am about to



remove # 8 and begin to glue it in place.

Using the fine brush and white glue under the wing of # 7 before sliding # 8 into position, hold for a few seconds before holding back the right hand wing of # 8 to place

A Very Easy Triangle Tea Bag Fold--- Windmill



glue to attach the left hand side of # 1.

I have made a white 14.5 x 11 cm backing sheet and attached the main image from the sheet provided. I found the centre point of the blank 8 pointed shape and used a piercing tool to make a hole. I have then attached a decorative split pin to push through the centre of the completed medallion and then through the hole I had already pierced. I have left the tea bag windmill medallion loose



enough to spin.

I completed the card front by attaching the gingham ribbon and bow, and attached this topper to the green and white multi striped 15.5 cm x 12 cm card front. The main card has the stripe printed on one side and a delicate floral on the other. This has formed the inside of the card. I have added the



printed sentiment to the card front.

I have included a small photograph of the insert complete with the verse I have written. I will post this on the free verses for your use, if you wish to take

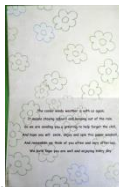

advantage of the free opportunity this section offers.

Thank you for taking the time to browse this section and look at this tutorial. I hope if you have never tried to delve into this type of paper craft as an addition to card making embellishment, that you will make use of the above instructions. Pamela Horton. The Whispering Platypus