

3D Room with a View Kit Tutorial (Gone for a Cuppa Garden Shed shown)

Template Design by Sue Douglas, exclusively at

<http://www.craftsuprint.com/sue-douglas/>

This new 3d kit, is really easy to make, and folds flat for posting. A unique and original card, that is sure to take pride of place, on your recipients' mantelpiece, or if you sell your cards, on your craft stall!

Finished Sizes:

3d Room with a View Card 7 5/8in x 7 5/8in (19.3cm x 19.3cm) which fits into a standard 8in x 8in Envelope
Depth (from Frame to back of 'room') when standing fully open 2 1/2in (6.5cm)
Width when standing fully open 12 5/8in (32cm)

Materials Required:

6 Sheets A4/Letter Size 250gsm Cardstock or 200gsm Photo Paper.

2 Sheets A4/Letter Size 160gsm Plain Cardstock for reinforcement

Photo Glue or Wet Glue

Double-sided tape

3d Sticky Foam Pads for Sentiment Label (D)



3d Room with a View – Gone for a Cuppa Garden Shed

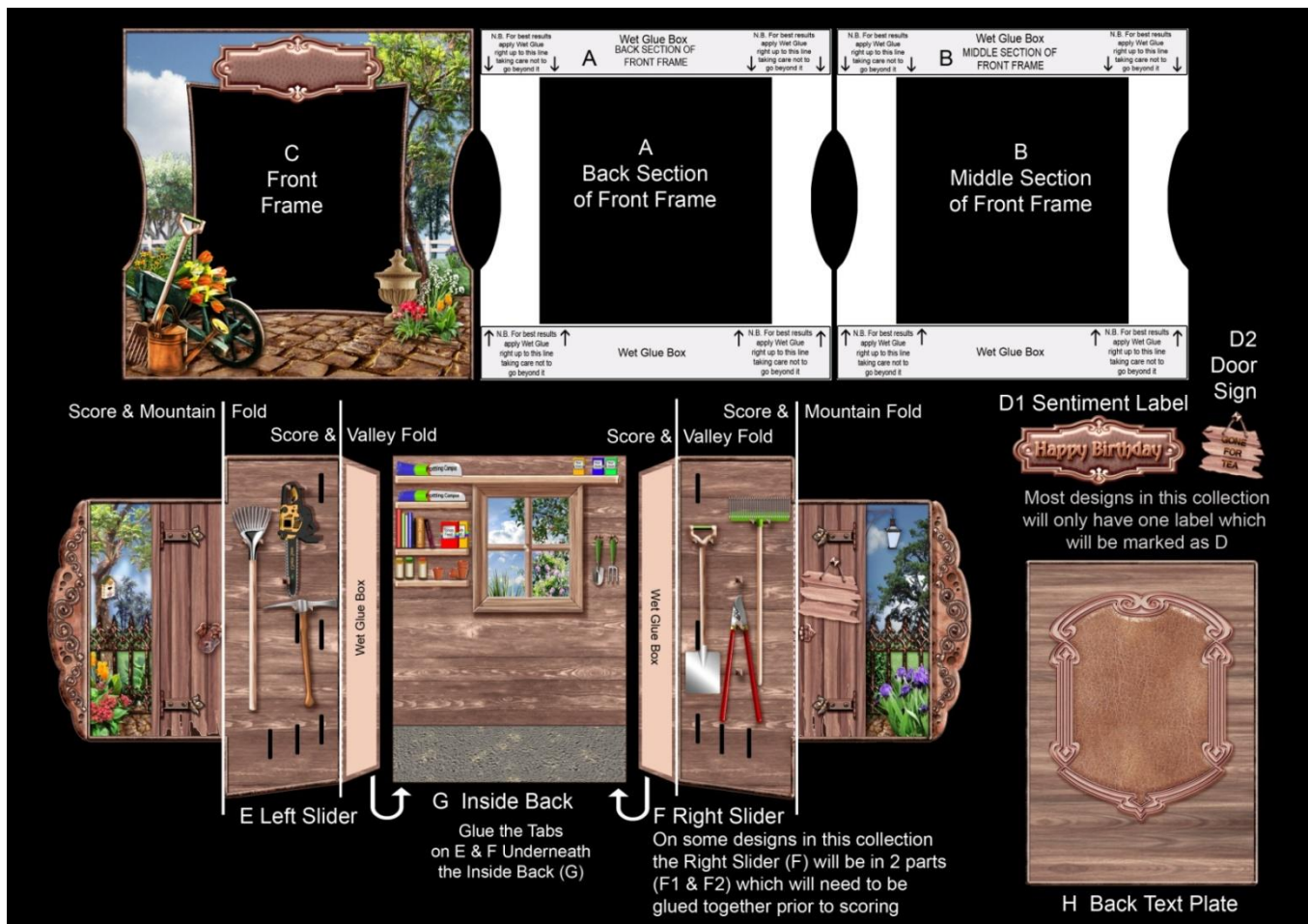

Cut, Score and Fold

A Back Section of Front Frame

B Middle Section of Front Frame

C Front Frame

D Sentiment Label (Those designs with 2 different Labels (as is the case with this 'Gone for a Cuppa Garden Shed' design) will be marked as D1 and D2 instead of D)

You only need to cut out those Labels you are going to be using on your card.

Sometimes the extra label may be attached to the Front Frame or the Back Text Plate or the Slider 'Doors', as is the case with this specific design shown in this tutorial. Any labels that are on the Slider 'Door' such as the Door sign, MUST be attached flat with a wet glue or double-sided tape so that the slider mechanism runs smoothly.

E Left Slider

F Right Slider (There are a couple of designs where this piece (F) will come in 2 parts and will need to be Glued together. The two parts will be marked as F1 and F2 instead of F and instructions for gluing them together will be shown on the actual sheets, where this is the case)

G Inside Back

H Back Text Plate

N.B. Leave the Upright pieces (J, K, L & M), for the moment as they need to be reinforced with card before cutting, and this will be explained in the next step.

Cut out all the pieces above (A to H only), and score and fold as shown in the above photograph.



Roughly Cut Around the Upright Pieces and attach to a piece of Card to reinforce them

J Back Upright

K Top Back Upright (On some Designs this piece will be labeled K Top Middle Upright)

L Middle Upright

M Front Upright

Using a wet glue, attach the above uprights (J, K, L & M) to a sheet of plain card
Cut out properly once dry.

J, K L, and M Upright Sliders Score Lines

K Top Back Upright Slider (on some designs K Top Middle Upright)



On all uprights
Score & Fold along the
dotted line with a
Valley Fold

On some designs the Top Uprights will either be slotted into the Top Back Slots on the Left and Right Sliders (or the Top Middle slots but they will always be labelled as K and will be named as Top Back Upright or Top Middle Upright

J Back Upright Slider



On all uprights
Score & Fold along the
dotted line with a
Valley Fold

L Middle Upright Slider



On all uprights
Score & Fold along the
dotted line with a
Valley Fold

M Front Upright Slider

On all uprights
Score & Fold along the
dotted lines with a
Valley Fold



J, K L, and M Upright Sliders Valley Folds



Score and Fold Uprights

J Back Upright

K Top Back Upright (On some Designs this piece will be labeled K Top Middle Upright)

L Middle Upright

M Front Upright

Score and fold where shown above. All the folds in the Upright pieces (J, K, L & M) are Valley Folds

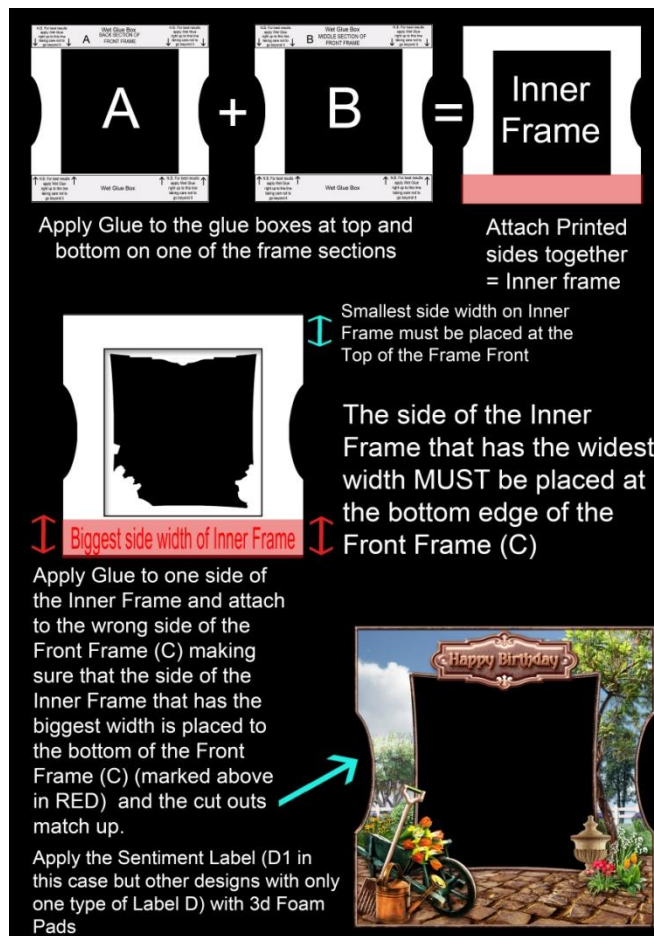

Making the Frame

A Back Section of Front Frame

B Middle Section of Front Frame

C Front Frame

D Sentiment Label (Some of the designs have 2 Labels which will be marked with D1 & D2 such is the case with this 'Gone for a Cuppa Garden Shed' design)

Apply a wet glue to the Top and Bottom glue boxes on the Back Section of Front Frame (A) N.B. Please don't add any glue to the sides of these pieces, only apply glue to the Top and Bottom Glue Boxes, otherwise you will have trouble later on getting the sliders to work.

Stick A and B together, (printed sides together), making sure that the pieces line up perfectly, as the bottom of the frame is wider than the top. So this will now be your Inner Frame Pencil, in which is the bottom side (the widest part) of the Inner Frame. This is what will be used to hold the Left and Right Sliders (E & F) later on.

Place the Front Frame (C) wrong side upwards, with the bottom edge closest to you. On one side, of the Inner Frame (A or B), apply a Wet Glue all over, and attach on to the wrong side of the Front Frame (C), again with the bottom edge of the Inner Frame closest to you, making sure to match the cut outs together. (See middle picture in the above photograph. If you find that the cut outs are not matching up exactly, it is most likely that you are using the top of the inner frame at the bottom, rather than the bottom (which is the widest part of the frame surround).

Attach the Sentiment Label (D1) , (or D on other designs that only have one type of Label) with 3d Foam Pads

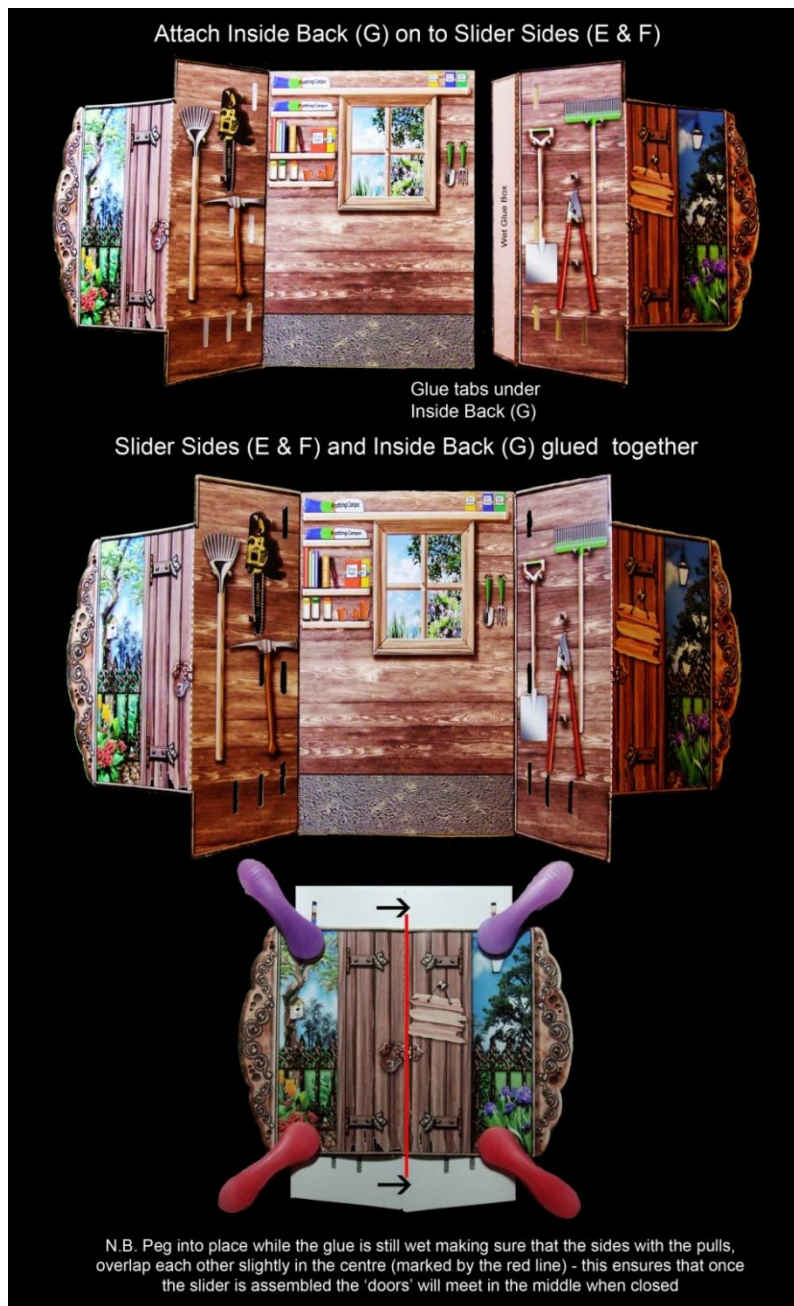

Attaching the insides of the card together

E Left Slider

F Right Slider (There are a couple of designs where this piece (F) will come in 2 parts and will need to be glued together, prior to this step. The two parts will be marked as F1 and F2 instead of F and the instructions for gluing them together will be shown on the actual sheets, where this is the case)

G Inside Back

Using a wet glue apply glue to the Glue Boxes on the printed sides of the Left and Right Sliders (E & F). Place the Inside Back (G) right side towards you on top of the tabs that you have just applied glue to. It is important that you push the inside back (G), right into the fold line of the tab. While the glue is still wet, fold the sides in as shown in the bottom picture above, and peg into place until dry, making sure that the centre of the Slider 'Doors' are slightly overlapping, this will ensure that the 'doors' meet in the centre, when the card is assembled and folded flat for posting.



Attach the Back Text Plate and Reinforce Left and Right Slider Doors

H Back Text Plate
D2 Door Sign

For those designs with 2 Labels they will be labeled D1 & D2 (as they are in the Gone for a Cuppa Garden Shed design that is shown in this tutorial). Sometimes the extra label may be attached to the Front Frame or the Back Text Plate or on the Slider 'Doors', as is the case with this specific design. Any labels that are on the Slider 'Door' MUST be attached flat with a wet glue or double-sided tape so that the slider mechanism runs smoothly. Apply a wet glue to the Back Text Plate (H) and attach to the back of the card (i.e. wrong side of the Inside Back)

Reinforce the Slider Door portions by attaching plain card with a wet glue, for reinforcement and then once dry cut around the Slider 'Doors'. This will ensure that your slider glides smoothly, when you pull the sides apart to reveal your 3d Room!



Feed the Uprights through the Side Slots

In the following order, feed the Uprights through the Left Hand side slots first, (as shown in the first picture above). You will need to fold the tabs to get them easily through the slots. Once the tab is through to the other side open it out, this will ensure it doesn't come out!

J Back Upright

K Top Back Upright (This will on some designs be labelled K Top Middle Upright but if you always attach the Back Upright (J) first, you will then easily see whether there slots for the Top Upright (K) in the Top Back position or the Top Middle position)

L Middle Upright

M Front Upright

Then feed the Right Hand Tabs on the Uprights, through the Right Hand side slots, again, working from the Back Upright, through to the Front Upright, opening out the tabs once slotted through, as you do each one.



Thread the 'Doors' through the opening in the Inner Frame on the left side. Do the same on the right side.

Thread the Slider 'Doors' through the Inner Front Frame

Thread the Slider 'Doors' between the opening of the side pieces of the Inner Frame, constructed earlier, which is attached to the Front Frame (C). This is the reason why the glue was only applied to the Glue Boxes Top and Bottom on the Back Section of Front Frame (A) and Middle Section of Front Frame (B) in order to make the opening for the slider 'doors' to be placed into.

Do this for both sides. Pull the sides apart, by placing your thumb and fingers of both hands in the cut outs on the Front Frame.

Top Tip

If you find that the doors are tending to spring back towards the centre, when pulling out the slider sides, remove the Slider 'Doors' from the Front Frame, and burnish the fold with your bone folder, folding the fold both ways a few times finishing off with a Mountain Fold, and place back into the Front Inner Frame, and that should fix the problem for you!

3d Room with a View Front View

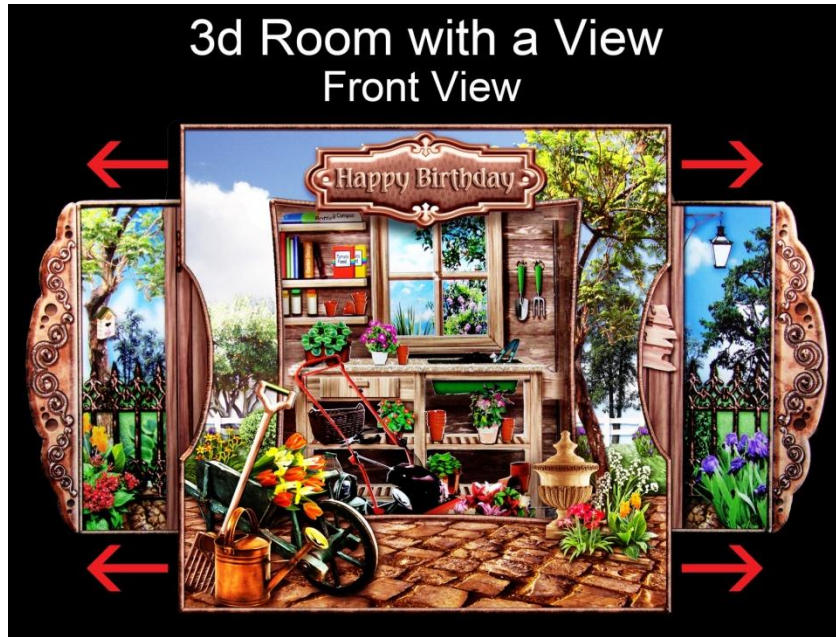

3d Room with a View Final Views

Folds Flat for Posting

Left View



Right View



Back View

So that's it, a beautiful original card with that 'WOW' factor, that folds flat for posting in a standard 8in x 8in Envelope. Other designs in my 3d Room with a view card are available for you to purchase, please click on the links below, to see them! There is also a small collection of my other kits that are available at Crafts U Print you might like to purchase!

©2012 Sue Douglas.

<http://www.craftsuprint.com/sue-douglas/>

Unregistered Design Rights Owned By Sue Douglas

Please see below for other designs in my 3d Room with a View Card Kits available exclusively from **CraftsUPrint**

<http://www.craftsuprint.com/sue-douglas/> – please click on the link below the previews:



[3d Room with a View Kits](http://www.craftsuprint.com/sue-douglas/)

3d Room with a View Kit
Gone for a Cuppa Garden Shed

Unregistered Design Rights
owned by Sue Douglas

Back Text Plate & a
Range of Sentiments are Included

Pull the Slider Sides Apart to Reveal a
Free Standing 3d Room!
that Folds Flat
for Posting

Flattened View
Fits an 8in x 8in
Envelope

Exclusive Design Purchased from www.CraftsUPrint.com/sue-douglas/

3d Room with a View Kit
Pamper Yourself

Unregistered Design Rights
owned by Sue Douglas

Back Text Plate & a
Range of Sentiments are Included

Pull the Slider Sides Apart to Reveal a
Free Standing 3d Room!
that Folds Flat
for Posting

Flattened View
Fits an 8in x 8in
Envelope

Exclusive Design Purchased from www.CraftsUPrint.com/sue-douglas/

**Left
Inside View**

**Right Inside
View**

**Left
Inside View**

**Right Inside
View**

[3d Room with a View Kits](#)

3d Room with a View Kit Let's Rock!

Unregistered Design Rights
owned by Sue Douglas

Back Text Plate & a
Range of Sentiments are Included

Pull the Slider Sides Apart to Reveal a
Free Standing 3d Room!
that Folds Flat
for Posting

Flattened View
Fits an 8in x 8in
Envelope

Exclusive Design Purchased from www.CraftsUPrint.com/sue-douglas/

3d Room with a View Kit My Craft Room

Unregistered Design Rights
owned by Sue Douglas

Back Text Plate & a
Range of Sentiments are Included

Pull the Slider Sides Apart to Reveal a
Free Standing 3d Room!
that Folds Flat
for Posting

Flattened View
Fits an 8in x 8in
Envelope

Exclusive Design Purchased from www.CraftsUPrint.com/sue-douglas/

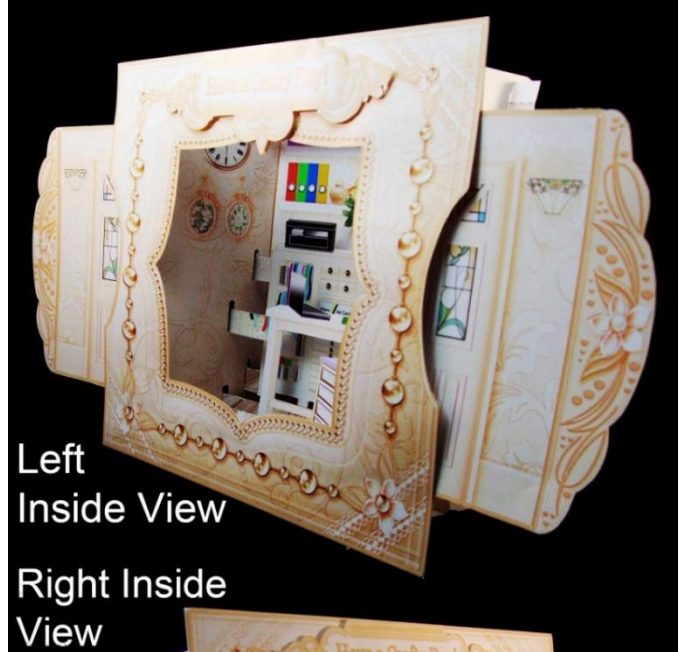

[3d Room with a View Kits](#)

3d Room with a View Kit
Sweet Dreams New Baby Girl

Unregistered Design Rights
owned by Sue Douglas

Back Text Plate & a
Range of Sentiments are Included

Pull the Slider Sides Apart to Reveal a
Free Standing 3d Room!
that Folds Flat
for Posting

Flattened View
Fits an 8in x 8in
Envelope

Exclusive Design Purchased from www.CraftsUPrint.com/sue-douglas/

3d Room with a View Kit
Sweet Dreams New Baby Boy

Unregistered Design Rights
owned by Sue Douglas

Back Text Plate & a
Range of Sentiments are Included

Pull the Slider Sides Apart to Reveal a
Free Standing 3d Room!
that Folds Flat
for Posting

Flattened View
Fits an 8in x 8in
Envelope

Exclusive Design Purchased from www.CraftsUPrint.com/sue-douglas/

Left Side View

Right Side View

Left Inside View

Right Inside View

[3d Room with a View Kits](#)

3d Room with a View Kit Vintage Music Room

Unregistered Design Rights
owned by Sue Douglas

Back Text Plate & a
Range of Sentiments are Included

**Pull the Slider Sides Apart to Reveal a
Free Standing 3d Room!**
that Folds Flat
for Posting

Flattened View
Fits an 8in x 8in
Envelope

Exclusive Design Purchased from www.CraftsUPrint.com/sue-douglas/

3d Room with a View Kit The Boudoir

Unregistered Design Rights
owned by Sue Douglas

Back Text Plate & a
Range of Sentiments are Included

**Pull the Slider Sides Apart to Reveal a
Free Standing 3d Room!**
that Folds Flat
for Posting

Flattened View
Fits an 8in x 8in
Envelope

Exclusive Design Purchased from www.CraftsUPrint.com/sue-douglas/

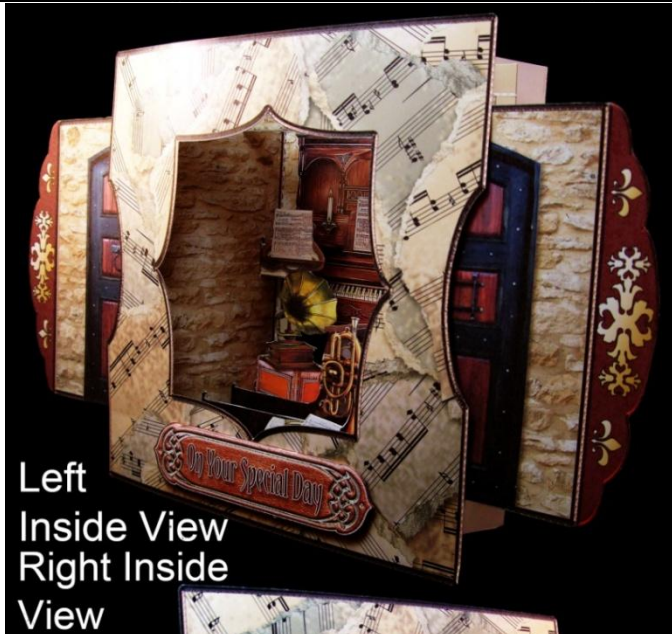

[3d Room with a View Kits](#)

A few of my other designs available only from **CraftsUPrint**
<http://www.craftsuprint.com/sue-douglas/> – please click on the link below the previews:



Acetate Window Card & Envelope Kits



Acetate Window Card & Envelope Kits



8in x 8in Easel Kits



8in x 8in Easel Kits



[Gift Card Money Envelope Kits](#)



[Gift Card Money Envelope Kits](#)



[Gift Card Money Envelope Kits](#)

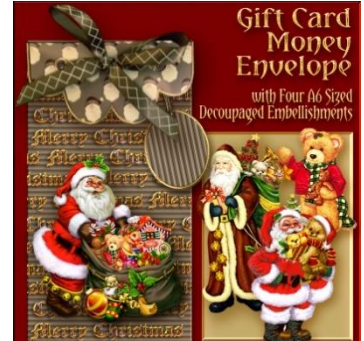

[Gift Card Money Envelope Kits](#)



[Gift Card Money Envelope Kits](#)

My designs are only available to purchase, exclusively from [CraftsUPrint](http://www.craftsuprint.com). Please do not share.

Look out for more new concepts coming soon!

<http://www.craftsuprint.com/sue-douglas/>